



# CONNECTION TECHNIQUES

## FOR PLASTIC PIPING SYSTEMS

- ✓ Solvent cements
- ✓ Fixation agent
- ✓ Cleaners
- ✓ Tools
- ✓ Lubricants
- ✓ Thread sealing



[www.griffon.eu](http://www.griffon.eu)

Griffon. The choice of the pro.



# GRIFFON. FAST, EASY & RELIABLE CONNECTIONS

As a specialist in connection techniques for plastic piping systems, Griffon offers a unique and complete range of high-quality cements, cleaners, tools, lubricants and thread sealing solutions for PVC, CPVC, ABS, PE, and PP. With these products the professional is assured of reliable pipe connections in both pressure and drainage systems. Ease of use is one of the core values of Griffon. Therefore, all of the Griffon cements for plastic piping systems have a unique plastic smart bottle with a large, quick-release cap with ergonomic grip. For fast, easy and clean application of the cement, a special brush and innovative brush wiper are integrated in each bottle. Furthermore, all Griffon cements meet important international standards and have several local approvals. So, no matter what kind of plastic piping system you wish to connect, Griffon provides the best solution for the job.

With sales offices in the Netherlands, Belgium, France, Germany, Spain, Portugal, Italy and Greece and distributors in many countries across the world, Griffon has built up a strong international market position. Well-known Griffon products are UNI-100®, WDF-05®, T-88® and Blue Gel.



## QUALITY

Opting for Griffon means opting for quality. In order to be able to constantly guarantee excellent quality Griffon employs a quality assurance system. This covers the entire process of incoming raw materials, production into the final product and delivery in accordance with prescribed and monitored procedures. This system has of course been ISO 9001 certified. In this way the user can be assured of a guaranteed quality level. Product quality focused on specific applications is guaranteed by approval marks such as British Standard, CSTB, KIWA and DVGW.

Furthermore, nearly all products have the CE marking and comply with relevant EN standards. Both product and process quality are subject to ongoing evaluation by reputable, independent inspection bodies, both locally and internationally.



## INNOVATION

In addition to quality, innovation is one of Griffon's core values. Griffon is continuously looking for new and better solutions. Existing products are constantly improved so that they do not only work better, but also are more user and environmentally friendly.

Through extensive research and close contact with end-users and manufacturers Griffon introduces innovative solutions for connecting problems time and again.

## SUSTAINABILITY | ecovadis

Griffon builds sustainability into every connection. Guided by the four EcoVadis pillars—Environment, Labor & Human Rights, Ethics, and Sustainable Procurement—Griffon designs products that are both recyclable and built to last. PVC connections made with Griffon products have a lifespan of 50 to 100 years, reducing waste and supporting a circular economy. With ethical sourcing and long-term durability, Griffon creates smarter, more responsible solutions for the future.

## SERVICE

In addition to quality and innovation we consider the service to our customer as a high priority. The Griffon information centre is always willing to answer any questions you might have.

Information number: +31 (0)88 3235700 or use the contact form on our website: [www.griffon.eu](http://www.griffon.eu)

Technical documentation sheets and safety data sheets are also available on our website.





# INDEX

THE GRIFFON SMART BOTTLE	7
--------------------------	---

<b>SOLVENT CEMENTS</b>	<b>8</b>
------------------------	----------

<b>PVC-U</b>	
UNI-100®	9
UNI-100® XT	11
UNI-100® GT	13
WDF-05®	15
T-88®	17

<b>PVC-C</b>	
HT-120® FLOWGUARD	18
HT-120®	19

<b>ABS</b>	
B-21	20
B-25	20

<b>FIXATION AGENT</b>	<b>21</b>
-----------------------	-----------

<b>PE / PP</b>	
F-40	21

<b>CLEANERS</b>	<b>22</b>
CLEANER	22
PE CLEANER HEAVY DUTY	23
PE CLEANER WIPES SPECIAL	23

<b>TOOLS</b>	<b>24</b>
CLEANER CLOTH	25
CHAMFER TOOL	25
CABLE SAW	25

<b>THE PERFECT CONNECTION</b>	<b>26</b>
-------------------------------	-----------

<b>LUBRICANTS</b>	<b>28</b>
BLUE GEL	28
P-20	29
LUBRICANT	29

<b>THREAD SEALING</b>	<b>30</b>
KOLMAT® FIBRE SEAL	30
KOLMAT® FLON-100	31
KOLMAT® PLASTIC	31



# THE GRIFFON SMART BOTTLE WITH SPECIAL ROUND BRUSH AND INNOVATIVE WIPER



# SMART BOTTLE

**LARGE  
ERGONOMIC CAP**

**EASY TO OPEN  
& CLOSE**



**SPECIAL ROUND  
BRUSH FOR FAST  
& CLEAN  
APPLICATION**



**INNOVATIVE  
BRUSH WIPER  
INSIDE**



**NO SPILLAGE  
NO DRIPPING**

**ROBUST  
& DURABLE  
PLASTIC BOTTLE**

**SPECIAL RIDGES  
FOR OPTIMAL GRIP**



**THE GRIFFON SMART BOTTLE  
FAST, EASY & RELIABLE**



# SOLVENT CEMENTS

## FOR THE PERFECT CONNECTION

Griffon offers a range of high-quality solvent cements specifically developed for connections in high-end plastic pressure systems. These cements each have unique and specific properties and provide the best solution for each application.

### UNI-100®

Fast, thixotropic PVC cement for pressure pipe systems up to  $\varnothing 315$  mm, also approved for drinking water systems.



MAX  
16  
BAR

Ø  
315  
MM

GEL

Suitable for diameters ≤ 315 mm

Pressure resistance: 16 bar (PN 16)

Thixotropic, gap filling

For pressure and drainage systems

Approved for drinking water systems



### TECHNICAL SPECIFICATIONS & PROPERTIES\*

Colour after drying	Transparent
Viscosity	Approx. 1450 mPa·s
Pressure resistance	16 bar (PN 16)
Diametrical clearance / press fit	0.8 mm / 0.2 mm
Temperature resistance	60°C, peak load 95°C
Chemical resistance	Equal to PVC itself
Maximum pipe diameter	≤ 315 mm
Density	Approx. 0.98 g/cm³
Flash point	K1 (<21°C)
Shelf life	At least 24 months

### CURING TIMES\*\*

Ø	16 - 63 mm		75 - 110 mm		125 - 315 mm	
	10 bar	16 bar	10 bar	16 bar	10 bar	16 bar
Temp.						
5°C - 10°C	4 h	8 h	8 h	16 h	16 h	32 h
> 10°C	2 h	4 h	4 h	8 h	8 h	16 h

### APPLICATION

Indication of the number of connections per 1L:

Ø	32	40	50	63	75	90	110	125	160	200	250	315
#	650	290	160	100	90	70	40	30	20	12	8	5

\* Working conditions: Do not use in temperatures ≤ 5°C.

\*\* Curing time may vary depending on a.o. surface, product quantity used, humidity level and ambient temperature.



### FIELDS OF APPLICATION

For joining pipes, sockets and fittings with interference fit and loose fit (gap filling) in pressure and drainage systems. With special pipe brush for quick and easy application. Suitable for diameters & 315 mm. Max. 16 bar (PN 16). Maximal tolerances 0.8 mm diametrical clearance / 0.2 mm press fit. Suitable for e.g. pipe systems conforming to EN 1329, 1452, 1453, 1455 and ISO 15493 (PVC).



## UNI-100® XT

Thixotropic, THF-free PVC cement for pressure pipe systems up to  $\varnothing 400$  mm, also approved for drinking water systems.



MAX  
16  
BAR

Ø  
400  
MM

THF  
FREE

GEL

THF-free: more user and environmentally friendly

Suitable for diameters ≤ 400 mm

Pressure resistance: 16 bar (PN 16)

Thixotropic, gap filling

For pressure and drainage systems

Approved for drinking water systems

### TECHNICAL SPECIFICATIONS & PROPERTIES\*

THF-free	Yes
Colour after drying	Yellow (transparent)
Viscosity	Approx. 1450 mPa·s
Pressure resistance	16 bar (PN 16)
Diametrical clearance / press fit	0.6 mm / 0.2 mm
Temperature resistance	60°C, peak load 95°C
Chemical resistance	Equal to PVC itself
Maximum pipe diameter	≤ 400 mm
Density	Approx. 0.94 g/cm³
Flash point	K1 (<21°C)
Shelf life	At least 18 months

### CURING TIMES\*\*

Ø	16 - 63 mm			75 - 110 mm			125 - 400 mm	
	5 bar	10 bar	16 bar	5 bar	10 bar	16 bar	5 bar	10 bar
Temp.								
5°C - 10°C	6 h	12 h	24 h	12 h	24 h	48 h	36 h	72 h
> 10°C	2 h	4 h	8 h	4 h	8 h	16 h	12 h	24 h

### APPLICATION

Indication of the number of connections per 1L:

Ø	32	40	50	63	75	90	110	125	160	200	250	315	400
#	650	290	160	100	90	70	40	30	20	12	8	5	3

\* Working conditions: Do not use in temperatures ≤ 5°C.

\*\* Curing time may vary depending on a.o. surface, product quantity used, humidity level and ambient temperature.



kiwa



BELGAQUA

ACS



WRAS  
APPROVED MATERIAL

kiwa  
IT 0148413



DVGW  
CERT  
USA Konformität Hygiene

### FIELDS OF APPLICATION

For joining pipes, sockets and fittings with interference fit and loose fit (gap filling) in pressure and drainage systems. With special pipe brush for quick and easy application. Suitable for diameters ≤ 400 mm. Max. 16 bar (PN 16). Maximal tolerances 0.6 mm diametrical clearance / 0.2 mm press fit. Suitable for e.g. pipe systems conforming to EN 1329, 1452, 1453, 1455 and ISO 15493 (PVC).

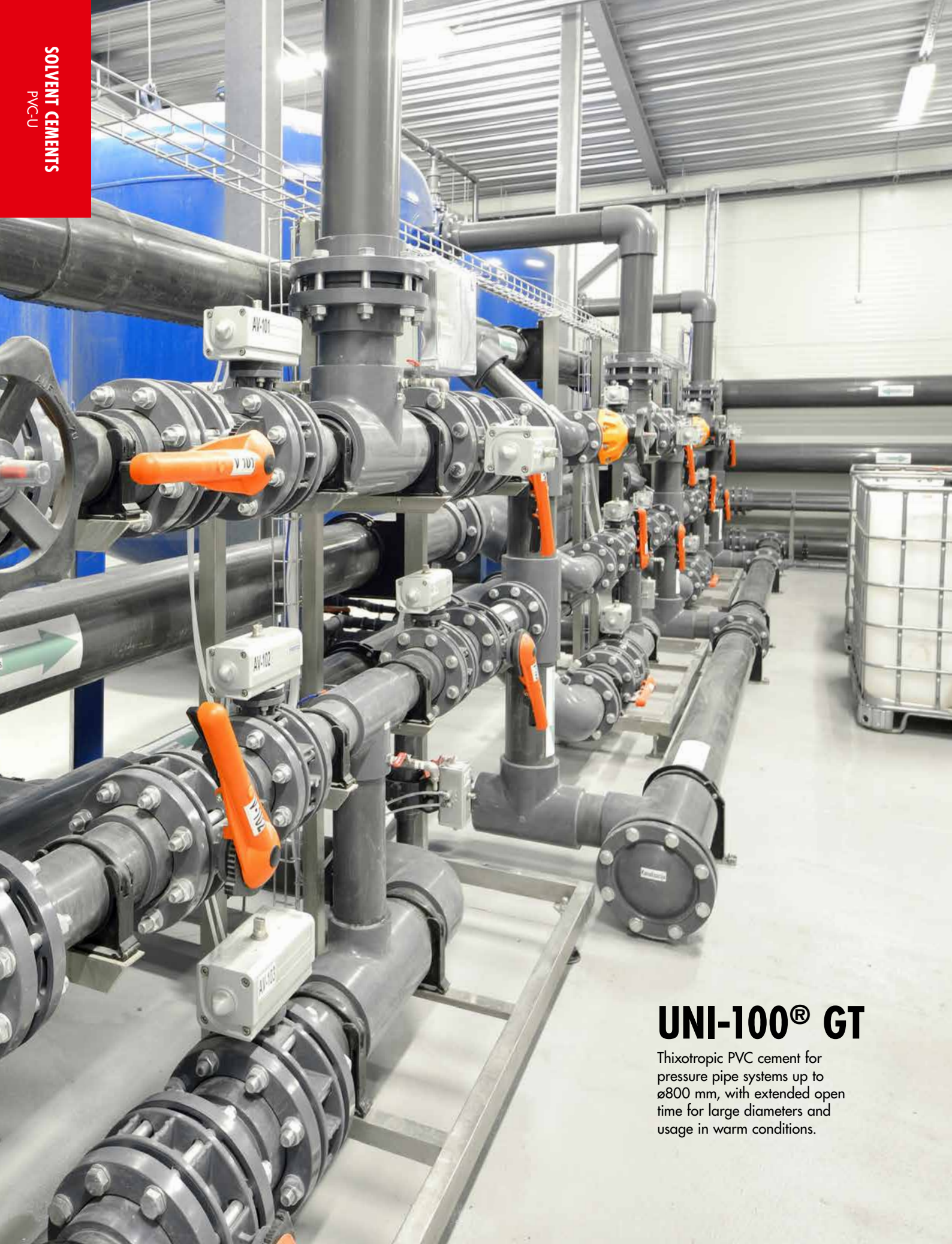

## UNI-100® GT

Thixotropic PVC cement for pressure pipe systems up to  $\varnothing 800$  mm, with extended open time for large diameters and usage in warm conditions.



MAX  
16  
BAR

Ø  
800  
MM

>35°C

SLOW  
DRYING

GEL

Extended open time

Suitable for application in higher temperatures (> 35°C)

Suitable for large diameters ≤ 800 mm

Pressure resistance: 16 bar (PN 16)

Thixotropic, gap filling

For pressure and drainage systems



EN 14814  
EN 14680



### TECHNICAL SPECIFICATIONS & PROPERTIES\*

Colour after drying	Yellow (transparent)
Viscosity	Approx. 1325 mPa·s
Pressure resistance	16 bar (PN 16)
Diametrical clearance / press fit	0.8 mm / 0.2 mm
Temperature resistance	60°C, peak load 95°C
Chemical resistance	Equal to PVC itself
Maximum pipe diameter	≤ 800 mm
Density	Approx. 1.00 g/cm³
Flash point	K1 (<21°C)
Shelf life	At least 24 months

### CURING TIMES\*\*

Ø	16 - 63 mm		75 - 110 mm		125 - 315 mm		400 - 800 mm	
Temp.	10 bar	16 bar	10 bar	16 bar	10 bar	16 bar	10 bar	16 bar
5°C - 15°C	8 h	16 h	16 h	32 h	32 h	64 h	64 h	128 h
10°C - 25°C	4 h	8 h	8 h	16 h	16 h	32 h	32 h	64 h
> 25°C	2 h	4 h	4 h	8 h	8 h	16 h	16 h	32 h

### APPLICATION

Indication of the number of connections per 1L:

Ø	32	40	50	63	75	90	110	125	160	200	250	315	400	800
#	650	290	160	100	90	70	40	30	20	12	8	5	3	1

\* Working conditions: Do not use in temperatures ≤ 5°C.

\*\* Curing time may vary depending on a.o. surface, product quantity used, humidity level and ambient temperature.

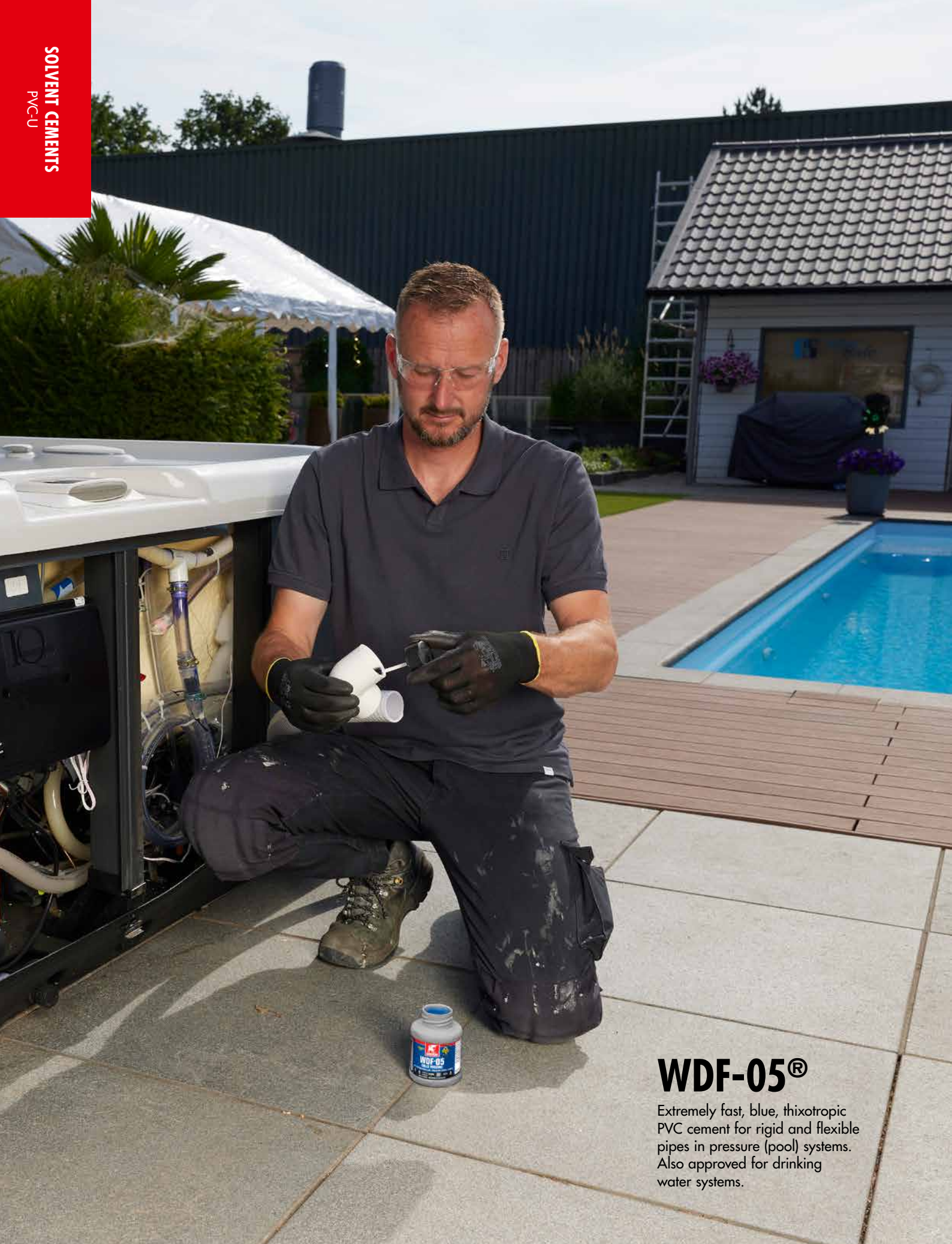

## WDF-05®

Extremely fast, blue, thixotropic PVC cement for rigid and flexible pipes in pressure (pool) systems. Also approved for drinking water systems.



Extremely fast

Suitable for diameters ≤ 160 mm

Pressure resistance: 16 bar (PN 16)

Thixotropic, gap filling

For pressure and drainage systems

Suitable for flexible hoses

Approved for drinking water systems

### TECHNICAL SPECIFICATIONS & PROPERTIES\*

Colour after drying	Blue (transparent)
Viscosity	Approx. 675 mPa·s
Pressure resistance	16 Bar (PN 16)
Diametrical clearance / press fit	0.8 mm (0.3 mm flexible tubing) / 0.2 mm
Temperature resistance	60°C, peak load 95°C
Chemical resistance	Equal to PVC itself
Maximum pipe diameter	≤ 160 mm
Density	Approx. 0.93 g/cm³
Flash point	K1 (<21°C)
Shelf life	At least 24 months



**EXTREMELY  
FAST**



### FIELDS OF APPLICATION

For joining pipes, sockets and fittings with interference fit and loose fit (gap filling) in pressure and drainage systems. Extremely suitable for flexible hoses and applications under wet conditions, such as swimming pools and whirlpools. With special pipe brush for quick and easy application. Suitable for diameters ≤ 160 mm. Max. 16 bar (PN 16). Maximal tolerances 0.8 mm diametrical clearance / 0.2 mm press fit. Flexible hoses 0.3 mm diametrical clearance. Suitable for e.g. pipe systems conforming to EN 1329, 1452, 1453, 1455 and ISO 15493 (PVC).

### CURING TIMES\*\*

Ø	16 - 50 mm			63 - 110 mm			125 - 160 mm		
Temp.	5 bar	10 bar	16 bar	5 bar	10 bar	16 bar	5 bar	10 bar	16 bar
5°C - 15°C	30 min	1 h	4 h	1 h	2 h	8 h	4 h	16 h	32 h
> 15°C	15 min	30 min	2 h	30 min	1 h	4 h	2 h	8 h	16 h

Flexible tubes 24 hours

### APPLICATION

Indication of the number of connections per 1L:

Ø	32	40	50	63	75	90	110	125	160
#	650	290	160	100	90	70	40	30	20

\* Working conditions: Do not use in temperatures ≤ 5°C.

\*\* Curing time may vary depending on a.o. surface, product quantity used, humidity level and ambient temperature.

## T-88®

THF-free, liquid PVC cement for pressure and drainage pipe systems up to  $\varnothing 160$  mm, also approved for drinking water systems.





# T-88®

## FAST, LIQUID, THF-FREE RIGID PVC CEMENT

MAX  
16  
BAR

Ø  
160  
MM

THF  
FREE

LIQUID

SOLVENT CEMENTS  
PVC-U

THF-free: more user and environmentally friendly

Suitable for (small) diameters ≤ 160 mm

Pressure resistance: 16 bar (PN 16) (for diameters ≤ 90 mm)

Liquid, ideal for tight fits

For pressure and drainage systems

Approved for drinking water systems

### TECHNICAL SPECIFICATIONS & PROPERTIES\*

THF-free	Yes
Colour after drying	Transparent
Viscosity	Approx. 375 mPa·s
Pressure resistance	16 bar (PN 16)
Diametrical clearance / press fit	0.3 mm / 0.2 mm
Temperature resistance	40°C, peak load 95°C
Chemical resistance	Equal to PVC itself
Maximum pipe diameter	≤ 160 mm
Density	Approx. 0.9 g/cm³
Flash point	K1 (<21°C)
Shelf life	At least 18 months



### FIELDS OF APPLICATION

For joining pipes, sockets and fittings with interference fit in pressure and drainage systems. With special pipe brush for quick and easy application. Suitable for diameters ≤ 160 mm (pressure ≤ 90 mm). Max. 16 bar (PN 16). Maximal tolerances 0.3 mm diametrical clearance / 0.2 mm press fit. Suitable for e.g. pipe systems conforming to EN 1329, 1452, 1453 and 1455.

### CURING TIMES\*\*

Ø	16 - 63 mm		75 - 90 mm		16 - 160 mm
	10 bar	16 bar	10 bar	16 bar	Non pressure
Temp.					
5°C - 10°C	4 h	8 h	8 h	16 h	2 h
> 10°C	2 h	4 h	4 h	8 h	1 h

### APPLICATION

Indication of the number of connections per 1L:

Ø	32	40	50	63	75	90	110	125	160
#	700	500	300	200	140	100	70	55	35

\* Working conditions: Do not use in temperatures ≤ 5°C.

\*\* Curing time may vary depending on a.o. surface, product quantity used, humidity level and ambient temperature.

# HT-120® FLOWGUARD

FAST, THIXOTROPIC, YELLOW  
PVC-C CEMENT



**FLOWGUARD®**  
PIPE & FITTINGS

Approved for Flowguard® systems

Suitable for diameters ≤ 315 mm

Pressure resistance: 25 bar (PN 25) (for diameters ≤ 110 mm)

Thixotropic, gap filling

Approved for drinking water systems



## TECHNICAL SPECIFICATIONS & PROPERTIES\*

Colour after drying	Yellow
Viscosity	Approx. 1500 mPa·s
Pressure resistance	25 bar (PN 25) diameters ≤ 110 mm (4") 16 bar (PN 16) diameters ≤ 250 mm (10") 10 bar (PN 10) diameters ≤ 315 mm (12")
Diametrical clearance / press fit	0.8 mm / 0.2 mm
Temperature resistance	80°C, peak load 120°C
Chemical resistance	Equal to PVC-C itself
Maximum pipe diameter	≤ 315 mm
Density	Approx. 0.99 g/cm³
Flash point	K1 (<21°C)
Shelf life	At least 24 months



## FIELDS OF APPLICATION

For joining pipes, sockets and fittings with interference fit and loose fit (gap filling) in pressure and drainage systems. With special pipe brush for quick and easy application. Applicable for cold and warm water up to 95°C. Suitable for cylindrical or conical fittings with diameters ≤ 315 mm (12"). Max. 25 bar (PN 25) for diameters ≤ 110 mm (4"). Max. 16 bar (PN 16) for diameters ≤ 250 mm (10"). Max. 10 bar (PN 10) for diameters ≤ 315 mm (12"). Maximal tolerances 0.8 mm diametrical clearance / 0.2 mm press fit. Suitable for pipe systems conforming to EN 1566, 15877 and ASTM Schedule 40 & 80.

## CURING TIMES\*\*

Ø	16 - 50 mm / ½ - 2"		63 - 110 mm / 2½ - 4"	
	10 bar	16 bar	10 bar	16 bar
Temp.				
-10°C - 5°C	16 h	-	72 h	-
5°C - 10°C	4 h	8 h	8 h	16 h
> 10°C	2 h	4 h	4 h	8 h

## APPLICATION

Indication of the number of connections per 1L:

Ø	32	40	50	63	75	90	110	125	160	200	250
#	650	290	160	100	90	70	40	30	20	12	8

\* Working conditions: Do not use in temperatures ≤ 0°C.

\*\* Curing time may vary depending on a.o. surface, product quantity used, humidity level and ambient temperature.



# HT-120®

## FAST, THIXOTROPIC PVC-C CEMENT

MAX  
25  
BAR

Ø  
250  
MM

GEL



SOLVENT CEMENTS  
PVC-C

**CORZAN**  
INDUSTRIAL SYSTEMS

Approved for Corzan® systems

Suitable for diameters ≤ 250 mm

Pressure resistance: 25 bar (PN 25) (for diameters ≤ 110 mm)

Thixotropic, gap filling



### TECHNICAL SPECIFICATIONS & PROPERTIES\*

Colour after drying	Yellow (transparent)
Viscosity	Approx. 1000 mPa·s
Pressure resistance	25 bar (PN 25) diameters ≤ 110 mm 16 bar (PN 16) diameters > 110 mm and ≤ 250 mm
Diametrical clearance / press fit	0.8 mm / 0.2 mm
Temperature resistance	95°C, peak load 120°C
Chemical resistance	Equal to PVC-C itself
Maximum pipe diameter	≤ 250 mm
Density	Approx. 0.99 g/cm³
Flash point	K1 (<21°C)
Shelf life	At least 24 months

**CORZAN**  
CPVC

EN 14814  
EN 14680



### FIELDS OF APPLICATION

For joining pipes, sockets and fittings with interference fit and loose fit (gap filling) in pressure and drainage systems. With special pipe brush for quick and easy application. Suitable for diameters & 250 mm. Max. 25 bar (PN 25) for diameters & 110 mm. Max. 16 bar (PN 16) for diameters > 110 mm and ≤ 250 mm. Maximal tolerances 0.8 mm diametrical clearance / 0.2 mm press fit. Suitable for e.g. pipe systems conforming to EN 1566, 15877 and ISO 15493 (PVC-C).

### CURING TIMES\*\*

Ø	16 - 63 mm		75 - 110 mm		125 - 250 mm		16 - 160 mm	200 - 250 mm
Temp.	10 bar	16 bar	10 bar	16 bar	10 bar	16 bar	NON PRESSURE	
5°C - 10°C	4 h	8 h	8 h	16 h	16 h	32 h	2 h	4 h
> 10°C	2 h	4 h	4 h	8 h	8 h	16 h	1 h	2 h

### APPLICATION

Indication of the number of connections per 1L:

Ø	32	40	50	63	75	90	110	125	160	200	250
#	650	290	160	100	90	70	40	30	20	12	8

\* Working conditions: Do not use in temperatures ≤ 5°C.

\*\* Curing time may vary depending on a.o. surface, product quantity used, humidity level and ambient temperature.

## B-21 | FAST, LIQUID ABS CEMENT

MAX  
10  
BAR

Ø  
160  
MM

THF  
FREE

LIQUID



EN 14814  
EN 14680



Fast

Suitable for diameters ≤ 160 mm

Pressure resistance: 10 bar (PN 10)

Liquid

For pressure and drainage systems

### TECHNICAL SPECIFICATIONS & PROPERTIES\*

Colour after drying	Transparent
Viscosity	Approx. 600 mPa·s
Pressure resistance	10 Bar (PN 10)
Diametrical clearance / press fit	0.3 mm / 0.2 mm
Temperature resistance	60°C, peak load 95°C
Chemical resistance	Equal to ABS itself
Maximum pipe diameter	≤ 160 mm
Density	Approx. 0.85 g/cm³
Flash point	K1 (<21°C)
Shelf life	At least 24 months

### FIELDS OF APPLICATION

For joining pipes, sockets and fittings with interference fit in pressure and drainage systems. With special pipe brush for quick and easy application. Suitable for diameters ≤ 160 mm. Max. 10 bar (PN 10). Maximal tolerances 0.3 mm diametrical clearance / 0.2 mm press fit. Suitable for e.g. pipe systems conforming to EN 1455 and ISO15493 (ABS).

## B-25 | FAST, THIXOTROPIC ABS CEMENT

MAX  
15  
BAR

Ø  
315  
MM

THF  
FREE

GEL



WRAS  
APPROVED MATERIAL

EN 14814  
EN 14680



Fast

Suitable for diameters ≤ 315 mm

Pressure resistance: 15 bar (PN 15)

Thixotropic, gap filling

For pressure and drainage systems

Approved for drinking water systems

### TECHNICAL SPECIFICATIONS & PROPERTIES

Colour after drying	Grey
Viscosity	Approx. 2500 mPa·s
Pressure resistance	15 Bar (PN 15)
Diametrical clearance / press fit	0.6 mm / 0.2 mm
Temperature resistance	60°C, peak load 95°C
Chemical resistance	Equal to ABS itself
Maximum pipe diameter	≤ 315 mm
Density	Approx. 0.89 g/cm³
Flash point	K1 (<21°C)
Shelf life	At least 24 months

### FIELDS OF APPLICATION

For joining pipes, sockets and fittings with interference fit and loose fit (gap filling) in pressure and drainage systems. Suitable for diameters ≤ 315 mm. Max. 15 bar (PN 15). Maximal tolerances 0.6 mm diametrical clearance / 0.2 mm press fit. Suitable for e.g. pipe systems conforming to EN 1455 and ISO 15493 (ABS).

\* Working conditions: Do not use in temperatures ≤ 0°C.



# F-40



## FIXATION AGENT FOR FIXING POLYPROPYLENE (PP) PIPES AND FITTINGS

FIXATION AGENTS  
PE / PP



Fast

Easy to apply

Thixotropic

Black

### TECHNICAL SPECIFICATIONS & PROPERTIES\*

<b>Colour after drying</b>	Black
<b>Chemical base</b>	Filler-containing synthetic rubber solution in a solvent mixture
<b>Viscosity</b>	Approx. 1800 mPa·s
<b>Solid contents</b>	Approx. 70%
<b>Density</b>	Approx. 1.5 g/cm <sup>3</sup>
<b>Flash point</b>	K1 (<21°C)
<b>Shelf life</b>	At least 12 months

### FIELDS OF APPLICATION

For fixing polypropylene (PP) pipes and fittings with rubber sleeve (sliding socket) connections in drain systems. Especially to prevent the drifting apart of pre-fab systems and folding of corners, for example, during transport.

### APPLICATION

#### Directions for use:

1. Cut pipes square, remove burrs and chamfer.
2. Clean surfaces.
3. Stir well before use.
4. Apply fixation agent to pipe end and rubber sleeve.
5. Join parts immediately by sliding the tube into the sliding socket until the stopper. Properly close the container immediately after use.

#### Stains/residue:

Remove adhesive stains with Griffon and Griffon Cleaner Cloth.

\* Working conditions: Do not use in temperatures  $\leq 5^{\circ}\text{C}$ .



## CLEANER

CLEANER FOR (RIGID) PVC, PVC-C AND ABS

Universal

Very powerful cleaning properties

### FIELDS OF APPLICATION

For cleaning and degreasing pipes, sockets and fittings of (rigid) PVC, PVC-C and ABS. Also suitable for removing uncured adhesive residue and for cleaning brushes and tools. Use in combination with Griffon Cleaner Cloth.

### APPLICATION

Indication of the number of connections per 1L:

Ø	32	40	50	63	75	90	110	125	160	200	250	315
#	800	700	650	550	330	250	160	140	90	50	35	23

### Directions for use:

1. Apply cleaner to a Griffon Cleaner Cloth.
2. Clean and degrease surfaces.
3. Remove any condensation with Griffon Cleaner Cloth and allow surfaces to dry properly. Close packaging immediately after use.

# GRIFFON CLEANERS

FOR THE MOST RELIABLE  
RESULTS

For powerful cleaning and degreasing pipes, sockets and fittings. Using Griffon Cleaner ensures that the surface is free of dirt and grease and will also prepare the surface for optimum adhesion.





## PE CLEANER HEAVY DUTY

CLEANSING AGENT FOR PE, PP, PVDF AND PB

Very Powerful cleaning properties

Rapid and complete vaporization

With special dosing cap

### FIELDS OF APPLICATION

For cleaning and degreasing pipes, sockets and fittings of PE, PP, PVDF and PB. Also suitable for cleaning welding equipment. Use in combination with Griffon Cleaner Cloth.

### APPLICATION

#### Directions for use:

1. Apply cleaner to a Griffon Cleaner Cloth.
2. Clean and degrease surfaces.
3. Remove any condensation with Griffon Cleaner Cloth and allow surfaces to dry properly. Close packaging immediately after use.



## PE CLEANER WIPES SPECIAL

CLEANING CLOTH FOR PE, PP, PVDF AND PB

**kiwa DoC**

Powerful cleaning properties

Rapid and complete vaporization

Lint-Free

Cloth size: 15 x 19.5 cm

### FIELDS OF APPLICATION

For cleaning and degreasing pipes, sockets and fittings of PE, PP, PVDF and PB. Also suitable for cleaning welding equipment.

### APPLICATION

#### Directions for use:

1. Clean and degrease surfaces
2. Remove any condensation with Griffon Cleaner Cloth and allow surfaces to dry properly. Wipe suitable for single use. Do not use dried up wipes. Close packaging immediately after use.

# GRIFFON TOOLS

CLEAN, EASY, FAST AND  
RELIABLE CONNECTIONS FOR  
PLASTIC PIPE SYSTEMS

In addition to the correct solvent  
cement and cleaner, the correct tools  
are also essential for making perfect  
joints in plastic pipe systems.



## CLEANER CLOTH

ABSORBENT, NON-PILLING CLOTH

**Absorbant**

**Non-pilling**

**Large cloths: 23 x 41 cm**

**Practical dispenser 100 pcs**

### FIELDS OF APPLICATION

For cleaning and degreasing (rigid) PVC, PVC-C, ABS, PE, PP, PVDF and PB pipes, sockets and fittings before joining. To be used in combination with Cleaner and PE Cleaner. Also suitable for removing non-hardened cement residue.

### APPLICATION

#### Directions for use:

1. Humidify cloth with (PE) Cleaner.
2. Clean and degrease surfaces.
3. Remove condensation, if any, with a clean, dry cloth and allow surfaces to dry well.



## CHAMFERING TOOL

FOR CHAMFERING PLASTIC PIPES

**Creates a chamfer angle of 15°**

**Prevents adhesive from being 'pushed away'**

### FIELDS OF APPLICATION

The Griffon Chamfering Tool is a handy, professional tool for chamfering the ends of plastic pipes. Chamfering the pipe to an angle of 15° ensures that the cement spreads more evenly, prevents scraping away the cement and creates a locating edge on the pipe end for easier assembly. The Griffon Chamfering Tool is suitable for PVC, PVC-C, ABS, PP and PE pipes with diameters between 16 and 63 mm.

### APPLICATION

#### Directions for use:

Five adapter rings for  $\varnothing$  20, 25, 32, 40 and 50 mm are integrated into the chamfering tool. To place these: Loosen the screws. Place the adapter rings of the desired diameter (for example, for a diameter of 40 mm place the adapter ring with a diameter of 50 and 40). Tighten the screw (not further than the adapter rings). The other adapter rings can be placed on the rear of the chamfering tool. Place the chamfering tool over the pipe and move it around until the entire pipe has a rim of 15°.

#### Points of attention:

Do not apply pressure on the pipe.

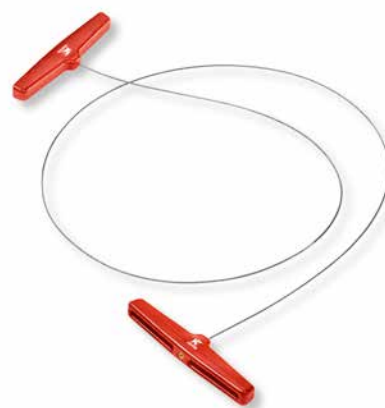

## CABLE SAW

FOR SAWING PLASTIC PIPES

**Ideal for use in places that are difficult to reach**

**Fine wire with rough saw cut for quick application**

**Sturdy handles**

**Length 90 cm**

### FIELDS OF APPLICATION

For plastic pipes of PVC, PVC-C, PP and PE.

### APPLICATION

#### Directions for use:

Place the wire on the pipe and move it back and forward in a sawing motion. The wire will curl.



# THE PERFECT CONNECTION STEP-BY-STEP PLAN

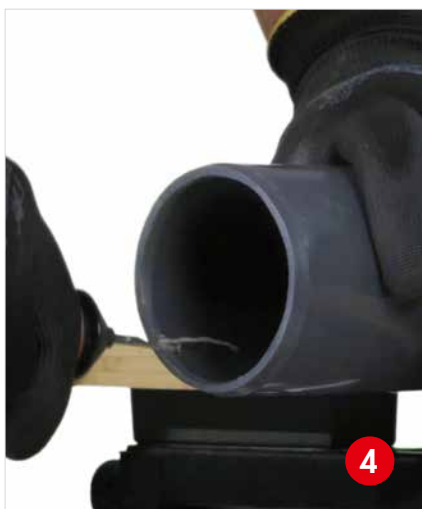

- 1 Measure and mark the pipe length
- 2 Cut the pipe square
- 3 Chamfer the outside of the pipe end
- 4 Deburr the inside of the pipe end
- 5 Measure and mark the insertion depth on the pipe
- 6 Mark position on the pipe and fitting

## REQUIRED MATERIALS:

- ✓ Measure tape or folding ruler
- ✓ Chamfering tool
- ✓ Deburring tool
- ✓ Griffon Cleaner
- ✓ Griffon Cleaner Cloth
- ✓ Marker

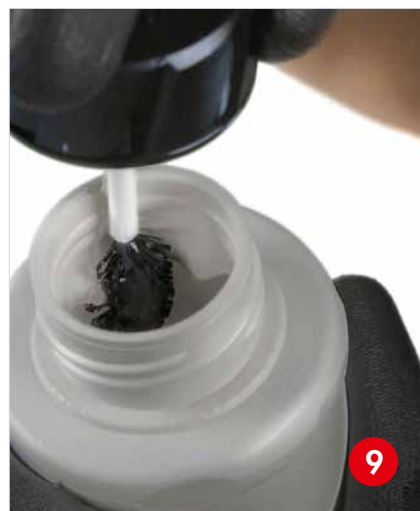

- 7 Clean inside of the fitting with griffon cleaner
- 8 Clean outside of the pipe with griffon cleaner
- 9 Optimize the amount of cement with the brush wiper
- 10 Apply cement rapidly and evenly all around the fitting (4-6x) with the round brush
- 11 Apply cement rapidly and evenly all around the pipe (4-6x) with the round brush
- 12 Assemble the pipe and fitting immediately in a smooth motion
- 13 Remove excess of cement





# GRIFFON LUBRICANTS

## FOR FITTING PIPES, SOCKETS AND FITTINGS WITH RUBBER SLEEVE CONNECTIONS

Special range of high quality lubricants for perfect rubber sleeve connections.



**ALSO AVAILABLE IN  
HANDY SQUEEZE BOTTLE**

Easy, hygienic, clean application

Attached sealing cap

## BLUE GEL

LUBRICANT FOR FITTING PIPES, SOCKETS AND FITTINGS  
WITH RUBBER SLEEVE CONNECTIONS

kiwa



ACS

SWRAS  
APPROVED MATERIAL

Approved for drinking water systems

Easy to apply on wet & dry surfaces

Odourless

Water-soluble

Acid-Free

Thixotropic

For pressure & drainage

## FIELDS OF APPLICATION

For fitting pipes, sockets and fittings with rubber sleeve (sliding socket) connections in pressure and drainage systems. Suitable for all diameters. Also for wet surfaces. Suitable for PVC, PVC-O, PE, PP, GRP, concrete and coated cast iron. Not suitable for ABS.

## APPLICATION

Indication of the number of connections per 1L:

Ø	32	40	50	75	90	110	160	250
#	900	600	400	200	135	90	45	20





ALSO AVAILABLE IN  
SPRAY (SILICONE OIL)

## P-20

LUBRICANT FOR FITTING PIPES, SOCKETS AND FITTINGS  
WITH RUBBER SLEEVE CONNECTIONS

kiwa

WRAS  
APPROVED MATERIAL

Approved for drinking water systems

Water-rinsable

Adjustable

Thixotropic

For pressure & drainage

### FIELDS OF APPLICATION

For fitting pipes, sockets and fittings with rubber sleeve (sliding socket) connections in pressure and drainage systems. Permitted for drinking water systems based on toxicological and bacteriological properties. Suitable for PVC-U, ABS, PE, PP, GRP, concrete and coated cast iron. Suitable for all diameters.

### APPLICATION

Indication of the number of connections per 1L:

Ø	32	40	50	75	90	110	160	250
#	900	600	400	200	135	90	45	20

## LUBRICANT

LUBRICANT FOR FITTING PIPES, SOCKETS AND  
FITTINGS WITH RUBBER SLEEVE CONNECTIONS

Adjustable

Acid-Free

Thixotropic

For drainage

### FIELDS OF APPLICATION

For fitting pipes, sockets and fittings with rubber sleeve (sliding socket) connections in drainage systems. Suitable for all diameters. Suitable for PVC-U, ABS, PE, PP, GRP, concrete and coated cast iron.

### APPLICATION

Directions for use:

1. Cut pipes square, chamfer edges and remove burrs.
2. Remove dirt and humidity.
3. Apply lubricant to pipe end and rubber sleeve.
4. Join parts immediately by sliding pipe into sliding socket until stopper. Connection can be corrected excellently.

Close packaging carefully immediately after use.  
Stains/residue: Remove stains with degreaser.



# KOLMAT® FIBRE SEAL

IMPREGNATED, FIBRE-REINFORCED SEALING TAPE



Fibre-reinforced

Re-adjustable > 180°

Removable

Immediately loadable

## TECHNICAL SPECIFICATIONS & PROPERTIES

Chemical base	Impregnated fiber tape
Colour	Green
Shelf life	At least 36 months

## FIELDS OF APPLICATION

For sealing conical and cylindrical metal and plastic threaded connections. Suitable e.g. for (drinking) water, gas, LPG (gas) and (compressed) air. Applicable for e.g. copper, brass, (galvanized) steel, stainless steel, chrome, zinc, PVC, CPVC and ABS. Gas: up to 5 bar pressure at -20°C - +70°C. Water up to 16 bar pressure at +95°C, up to 7 bar pressure at +130°C. Limited resistant to chemicals. Not suitable for oxygen.

## APPLICATION

Coverage:

Ø INCHES	# WINDINGS	Ø INCHES	# WINDINGS
1/4	2 - 3	1 1/2	5 - 6
3/8	2 - 3	2	5 - 6
1/2	3 - 4	2 1/2	6 - 7
3/4	4 - 5	3	7 - 8
1	4 - 5	4	8 - 9
1 1/4	5 - 6	6	8 - 9

## Directions for use:

1. Clean and degrease surfaces. Smooth surfaces such as brass, stainless steel and chrome must first be roughened.
2. Apply the dark green side of the tape to the thread, winding tightly and pressing it firmly in the direction of the thread while allowing a 50% overlap. If a 50% overlap is not possible, then apply 2-3 windings and pull tape tight, so that it is pressed into the screw thread. In case of a loose fit, it may be necessary to apply more windings.
3. Assemble joint. Joint is adjustable to at least 180°.



## KOLMAT® FLON-100

PTFE THREAD SEALING CORD FOR SEALING CONICAL METAL AND PLASTIC THREADED CONNECTIONS



KVBG ARGB

DVGW  
CERT  
UBA Konformität Hygiene

EN 751-3  
FRp/GRp

100% PTFE

UV resistant

Re-adjustable (45°)

Removable

Chemical resistant

Immediately loadable

Mould resistant

### TECHNICAL SPECIFICATIONS & PROPERTIES\*

Chemical base	PTFE
Colour	White
Pressure resistance	20 bar
Minimum temperature resistance	-200°C
Maximum temperature resistance	240°C

### FIELDS OF APPLICATION

Suitable for (drinking)water (cold & hot), steam, gas, LPG, fuels, solvents, (compressed) air, oxygen and acids and bases. Applicable for e.g. copper, brass, (galvanized) steel, stainless steel, chrome, zinc, PVC, CPVC and ABS. Gas: up to 20 bar pressure at -20°C - +125°C. Water (steam): up to 16 bar pressure at +95°C, up to 7 bar pressure at +130°C.

### APPLICATION

Coverage:

Ø INCHES	# WINDINGS
1/2	12 - 18
1 1/2	16 - 24

### Directions for use:

1. Start at the end of the tube and wrap the cord in the thread direction tightly on the screw thread. Overlap regularly. Apply sufficient cord in order to obtain a good seal mainly at the beginning of the tube (10-15mm).
2. Using the dispenser apply 2-3 drops of liquid to the cord and spread it with your finger over the entire surface.
3. After assembly do not turn back more than 45° (1/8 turn).

\* Working conditions: Do not use in temperatures ≤ 5°C.



## KOLMAT® PLASTIC

SEALANT FOR SEALING CONICAL AND CYLINDRICAL SYNTHETIC THREADED CONNECTIONS

THF-free

Fast

Liquid

### TECHNICAL SPECIFICATIONS & PROPERTIES

Pressure resistance (20°C)	8 bar
Pressure resistance (80°C)	2 bar
Shelf life	At least 15 months

### FIELDS OF APPLICATION

For sealing conical and cylindrical metal and synthetic threaded connections (synthetics/synthetics and synthetics/metal). Suitable for cold and warm water and (compressed) air. Suitable for, e.g., PVC, CPVC and ABS eventually in combination with copper, brass, (galvanized) steel and stainless steel.

### APPLICATION

#### Preliminary Surface Treatment:

Clean and dry surfaces with a degreaser (Griffon PE Cleaner) and use a clean, wellabsorbing, fluff-free cloth (Griffon Cleaner Cloth).

#### Directions for use:

Apply evenly to the male part and the female part. Assemble joint immediately and remove residues. Joint is adjustable for about 5 minutes. Joint can be loaded up to 8 bar (medium 20°C) or 2 bar (medium 80°C). After curing lightly demountable.



**“FOR PERFECT CONNECTIONS  
I RELY ON GRIFFON”**





[illegible]



[illegible]



**GRIFFON IS A BRAND OF  
BISON INTERNATIONAL**

**Griffon**

Dr. A.F. Philipsstraat 9

P.O. Box 160

NL-4460 AD Goes

Tel. +31 (0)88 3235700

[info@griffon.eu](mailto:info@griffon.eu)

[www.griffon.eu](http://www.griffon.eu)