

WATERPROOF & AIRTIGHT COATING

NEW

OF ANY CONSTRUCTION

Waterproof & airtight

Applicable on moist surfaces

In grey (RAL 7040) and white (RAL 9010)

Weather & UV resistant

Chlorine and salt water resistant

Excellent adhesion to many surfaces (without primer)

Self-levelling

Non-shrinking

Permanently elastic (>250%)

Paintable and plasterable

Free of bitumen, isocyanates and solvents



GRIFFON IS A BRAND OF BISON INTERNATIONAL

Griffon
Dr. A.F. Philipsstraat 9
P.O. Box 160
NL-4460 AD Goes
Tel. +31 (0)113235700
Fax. +31 (0)113232077
info@griffon.eu
www.griffon.eu



POWERFUL PROTECTION FOR ANY CONSTRUCTION.



POWERFUL PROTECTION FOR ANY CONSTRUCTION

SMP-300® WATERPROOF & AIRTIGHT COATING

- ✓ For many surfaces ✓ Non-shrinking
- ✓ Self-levelling ✓ Weather & UV resistant



The new powerful protective coating of Griffon for waterproof & airtight sealing and protection for any construction. SMP-300® is a premium 100% waterproof and airtight elastic coating based on innovative SMP-technology. Thanks to its excellent adhesion to many (damp) surfaces, SMP-300® is easy to apply in nearly any application, such as the sealing of floors, walls, seems, joints, and all other types of surfaces, penetrations and connections of building components and construction elements. Excellent for both indoor and outdoor applications and even applicable without primer.

Technical specifications

SMP-300®



SPECIFICATIONS

Colour after drying	Grey (RAL 7040), white (RAL 9010)
Viscosity	Thick liquid (higher viscosity in cartridges and sausages)
Density	Approx. 1.44 g/cm ³
Hardness (Shore A)	30±5
Chemical Base	SMP polymer
Tensile strength	100 N/cm ²
Available in	Cartridge 290 ml, Sausage 600 ml, Tin 1 kg, Bucket: 7 kg & 14 kg
Shelf life	At least 15 months in unopened package
Storage conditions	Properly sealed packages should be stored in a dry, cool location at temperatures between +5 °C and +25 °C

CURING TIME* AND APPLICATION

Water-resistant	Completely waterproof after 12 hrs
Working conditions	5 °C - 40 °C
Surface requirements	Surfaces must be dry, clean, and free of dust and grease
Apply with	Brush or paint roller
Dilute	No
Usage	Airtight constructions: 1.3 - 1.5 kg/m ² at a film thickness of 1.0 mm, waterproof constructions: 2.0 - 2.3 kg/m ² at a film thickness of 1.5 mm**

PROPERTIES

Water resistance	Very good
Temperature resistance	Between -40 °C and +100 °C
UV resistance	Very good
Salt and chemical resistance	Very good
Paintability	With acrylic and alkyd paints***
Elasticity	Good
Elongation of rupture	>250%

* Curing time may vary depending on a.o. surface, product quantity used, humidity level and ambient temperature.

** Coverage can vary according to the roughness of the substrate.

*** Drying time of alkyd paints may be extended.

CERTIFICATES & STANDARDS

	Products and systems for the protection and repair of concrete structures. Surface protection systems for concrete (EN 1504-2).
	Products and systems for the protection and repair of concrete structures. Surface protection systems for concrete (EN 1504-2).
	EMICODE: Classification system (GEV) of emission properties for construction products in indoor areas. EC-1 PLUS (very low emission PLUS).

TESTED ACCORDING TO STANDARDS

	Windows and doors - Air permeability
	Windows and doors - Watertightness
	Thermal performance of buildings - Air permeability of building components and building elements

DRYING / CURING TIMES****

	35% RH 10 °C	60% RH 20 °C	90% RH 30 °C
Skin formation time	135 min	60 min	30 min
Withstands light rain after	60 min	30 min	15-20 min
Withstands heavy rain after	2 hrs	50-60 min	50 min
Tack free time	±72 hrs	±48 hrs	±24 hrs

	10 °C	20 °C	30 °C
Skin formation time	10 °C	20 °C	30 °C
35% RH	135 min	80 min	50 min
60% RH	120 min	60 min	40 min
90% RH	105 min	50 min	30 min

**** Curing time may vary depending on a.o. surface, product quantity used, humidity level and ambient temperature.

STEP-BY-STEP PLAN: MAKING A WINDOW FRAME CONNECTION AIRTIGHT



- 1 Clean the surface.
- 2 Fill seams of >0.5 mm with FlexFoam-200.
- 3 After curing, push back FlexFoam-200.
- 4 Prepare the sausage or cartridge and the gun, then apply SMP-300®.
- 5 Spread the coating evenly with a brush (ensure a layer thickness of at least 1 mm).
- 6 100% airtight window frame connection.

REQUIRED MATERIALS

- ✓ SMP-300®
- ✓ FlexFoam-200
- ✓ Foam gun
- ✓ Brush
- ✓ A brush or paint roller

STEP-BY-STEP PLAN: WATERPROOFING A ROOF (SKYLIGHT)

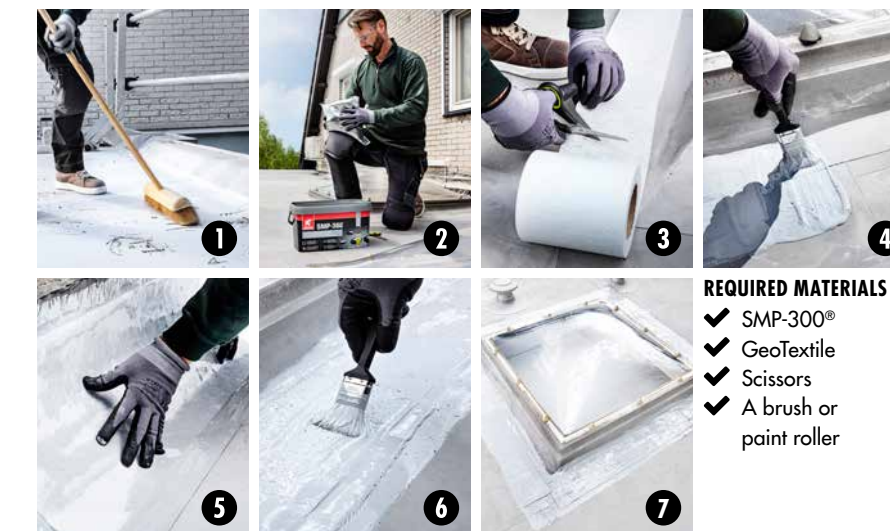

SKYLIGHTS:

- 1 Clean the surface and remove excess water.
- 2 Knead the bag and pour the coating in the bucket.
- 3 Cut GeoTextile in the right length. Overlap GeoTextile panels at least 5 cm.
- 4 Apply a first thick layer of SMP-300®.
- 5 Place GeoTextile on top of the first layer. Press GeoTextile into the coating until it's saturated completely.
- 6 Apply a second layer SMP-300® on top of GeoTextile within 1 hour. Ensure total layer thickness of at least 1.5 mm.
- 7 100% waterproof flat roof skylight.

IN CASE OF LARGE SURFACES:

- 1 Clean the surface and remove excess water.
- 2 Knead the bag and pour the coating in the bucket.
- 3 Apply SMP-300® coating with a brush on edges and corners.
- 4 Pour SMP-300® coating directly from the bag or bucket on the surface.
- 5 Roll out the coating with a roller. Ensure layer thickness of at least 1.5 mm.
- 6 100% waterproof flat roof.